

# VHM-Fräser / Solid carbide End Mills

## VHM - Gesenk fräser

Solid Carbide - Die - Milling End Mills

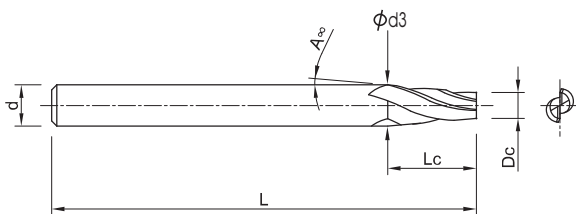

Art. TA 100 - Nr. 11302T



Dc Schneiden- Durchm	∠ Angle	Lc Schneiden- länge	φd3	φd3 Schaft- durchm	L Gesamt- länge	Schneiden
Mill Diameter	Angle	Length of Cut	φd3	Shank Diameter	Overall Length	No of Flute
1	30°	4	1.07	4	50	2
	1°		1.14			
	1°30"		1.21			
	2°		1.28			
	2°30"		1.35			
	3°		1.42			
	4°		1.56			
	5°		1.7			
	7°		1.98			
	10°		2.41			
	12°		2.7			
15°	3.14	6				
1.5	30°	5	1.59	4	50	2
	1°		1.67			
	1°30"		1.76			
	2°		1.85			
	2°30"		1.94			
	3°		2.02			
	4°		2.2			
	5°		2.37			
	7°		2.73			
	10°		3.26			
	12°		3.63			
15°	4.18	6				
2	30°	6	2.1	4	50	2
	1°		2.21			
	1°30"		2.31			
	2°		2.42			
	2°30"		2.52			
	3°		2.63			
	4°		2.84			
	5°		3.05			
	7°		3.47			
	10°		4.12			
	12°		4.55			
15°	5.22	6				
2.5	30°	8	2.64	4	50	2
	1°		2.78			
	1°30"		2.92			
	2°		3.06			
	2°30"		3.2			
	3°		3.34			
4°	3.62					

CONTINUE ⇒



2.5	5°	8	3.9	4	50	2
	7°		4.45	6		
	10°		5.32	8		
	12°		5.9			
	15°		6.79			
3	30"	10	3.17	6	50	2
	1°		3.35			
	1°30"		3.52			
	2°		3.7			
	2°30"		3.87			
	3°		4.05			
	5°		4.75			
	7°		5.46			
4	30"	15	4.26	6	50	2
	1°		4.52			
	1°30"		4.79			
	2°		5.05			
	2°30"		5.31			
	3°		5.57			
	5°		6.63			
	7°		7.68			
5	30"	20	5.35	6	60	2
	1°		5.7	8		
	1°30"		6.05			
	2°		6.4			
	2°30"		6.75	10		
	3°		7.1			
	5°		8.5			
6	30"	20	6.35	8	60	2
	1°		6.7			
	1°30"		7.05			
	2°		7.4			
	2°30"		7.75	10		
	3°		8.1			
	5°		9.5			
8	30"	25	8.44	10	75	2
	1°		8.87			
	1°30"		9.31			
	2°		9.75			
	2°30"		10.18	12		
	3°		10.62			

8	5°	25	12.37	12	100	2
10	30"	35	10.61	12	100	2
	1°		11.22			
	1°30"		11.83			
	2°		12.44			
	2°30"		13.05			
	3°		13.67			
	5°		16.12			

# VHM-Fräser / Solid carbide End Mills

## VHM - Radius Gesenk fräser

Solid Carbide - Die - Milling Radius End Mills

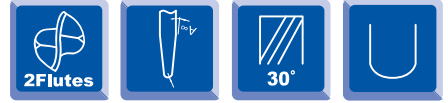
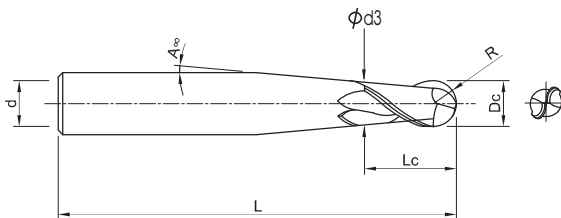

Art. TA 200 - Nr. 81302T

Dc Schneiden- Durchm	∠ Angle	Lc Schneiden- länge	φd3	φd Schaff- durchm	L Gesamt- länge	Schneiden
Mill Diameter	Angle	Length of Cut	φd3	Shank Diameter	Overall Length	No of Flute
0.5	30°	3	1.04	4	50	2
	1°		1.09			
	1°30"		1.13			
	2°		1.18			
	3°		1.26			
	5°		1.45			
	7°	6	2.36			
0.75	30°	6	1.59	4	50	2
	1°		1.68			
	1°30"		1.78			
	2°		1.87			
	3°		2.05			
	5°		2.42			
	7°		2.8			
1	30°	8	2.12	4	50	2
	1°		2.24			
	1°30"		2.37			
	2°		2.49			
	3°		2.74			
	4°		2.98			
	5°		3.23			
	7°	3.73	6			
1.25	30°	10	2.65	4	50	2
	1°		2.81			
	1°30"		2.96			
	2°		3.11			
	3°		3.42			
	4°		3.73			
	5°		4.04			
	7°	15	5.9	6		
1.5	7°	15	6.34	8	60	2

Ordering Example : Art. TA 200 - Nr. 81302T - Dia. 1.25mm

# VHM-Fräser / Solid carbide End Mills

## VHM - Eckenradius Gesenk fräser

Solid Carbide - Die - Milling End Mills with Corner Radius

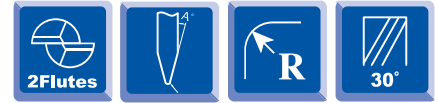

Art. TA 300 - Nr. 21302T

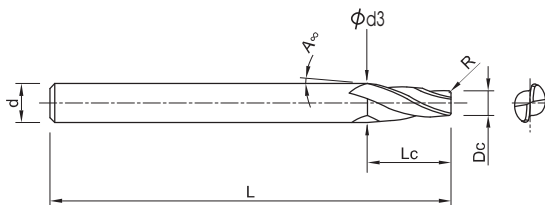

Dc Schneiden- Durchm	∠ Angle	Ecken- Radius	Lc Schneiden- länge	φd3	φd Schafft- durchm	L Gesamt- länge	Schneiden
Mill Diameter	Angle	Corner Radius	Length of Cut	φd3	Shank Diameter	Overall Length	No of Flute
2	7°	0.3	5	3.23	4	50	2
	10°			3.76			
	12°			4.13	6		
	15°			4.68			
2.5	7°	0.5	6	3.97	6	50	2
	10°			4.62			
	12°			5.05			
	15°			5.72			
3	7°	0.5	7	4.72	6	50	2
	10°			5.47			
	12°			5.98	8		
	15°			6.75			
	7°	1		4.72	6	50	
	10°			5.47			
	12°			5.98	8		
	15°			6.75			
3.5	7°	0.5	7	5.22	6	50	2
	10°			5.97			
	12°			6.48	8		
	15°			7.25			
	7°	1		5.22	6	50	
	10°			5.97			
	12°			6.48	8		
	15°			7.25			
4	7°	0.5	8	5.96	8	60	2
	10°			6.82			
	12°			7.4	10		
	15°			8.29			
	7°	1		5.96	8	60	
	10°			6.82			
	12°			7.4	10		
	15°			8.29			
4.5	7°	0.5	9	6.71	8	60	2
	10°			7.67			
	12°			8.33	10		
	15°			9.32			
	7°	1		6.71	8	60	
	10°			7.67			
	12°			8.33	10		
	15°			9.32			
5	7°	1	10	7.46	8	60	2
	10°			8.53			
	12°			9.25	10		
	15°			10.36			
	7°	1.5		7.46	8	60	
	10°			8.53			
	12°			9.25	10		
	15°			10.36			

Ordering Example : Art. TA 300 - Nr. 21302T - Dia. 3.5mm